

General information

Cavity

Type series: AB

Dimensions and sectional view

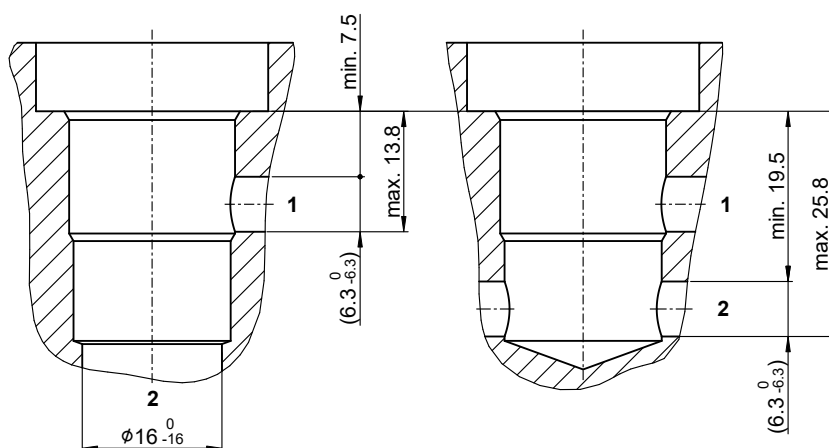
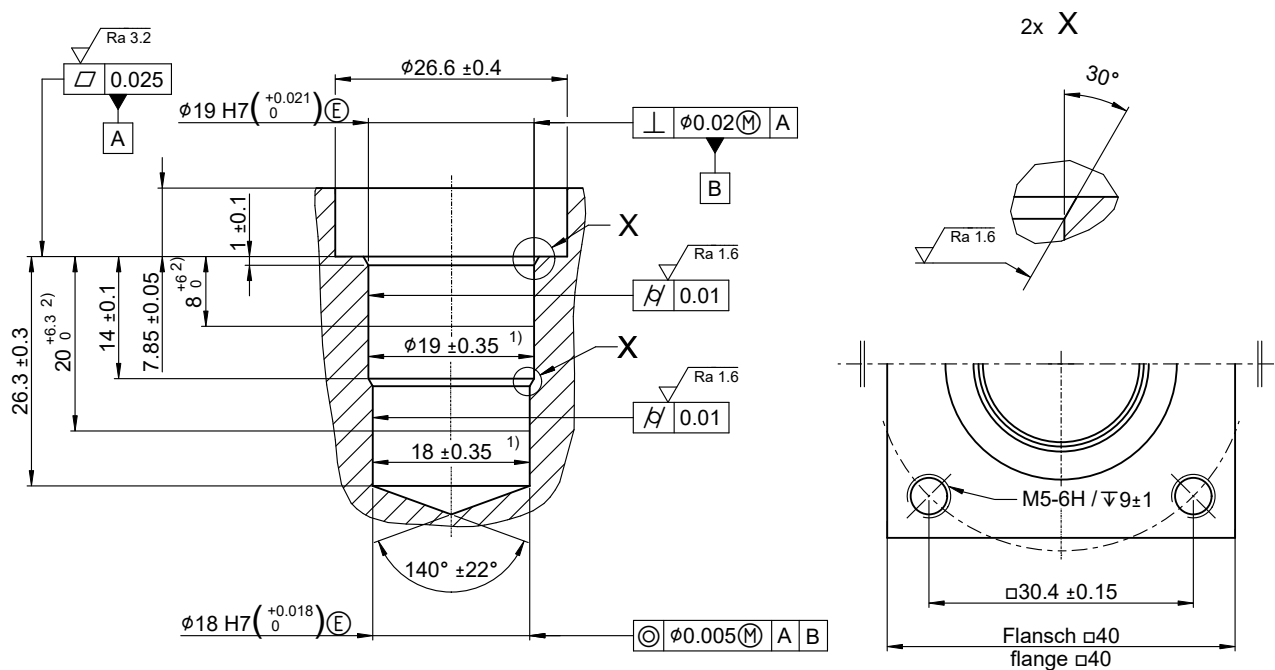

$\sqrt{Ra 6.3}$ (✓)

- 1) Vorbearbeitungs- ϕ / pre-drilling diameters
- 2) Passungstiefe / minimum depth of specified diametral tolerance

Installation information

**ATTENTION!**

You must maintain the specified positional and diametral tolerances. To ensure trouble-free operation of the screw-in cartridges, we strongly recommend that pilot drilling, boring, reaming and cavity thread-cutting are always performed in one setup.

**NOTE!**

We offer form tool sets for sale or hire. For further information, see data sheet 400-P-040011.

**NOTE!**

Cavity type to factory standard.